

IPOTEC

Innovation in Polymer Technology

Ipotec LLC, 41 Industrial Drive, Exeter, NH 03833, USA

Tel: (+1) (603) 778 2882 • Fax: (+1) (603) 778 2878 • <http://www.ipotec.com> • e-mail: info@ipotec.com

Expanded Silicone Rubber Extrusions

Available Dimensions for Tube Sections

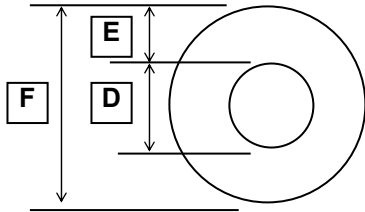

D (max) = 2.25in (57mm); D (min) = 0.080in (2.0mm)

E (max) = 0.75in (19mm); E (min) = 0.080in (2.0mm)

F (max) = 3.75in (95mm); D (min) = 0.250in (6.4mm)

The above dimension limits are for guidance only and may not be possible with all material grades

Standard dimensional tolerances +/-10%

Standard Sizes

| Inside Diameter D | | Wall Thickness E | | Outside Diameter F | | | | |
|-------------------|-------|------------------|-----|--------------------|-----|-------|-------|------|
| inch | mm | inch | mm | inch | mm | | | |
| 1/4 | 0.250 | 6.4 | 1/4 | 0.250 | 6.4 | 3/4 | 0.750 | 19.1 |
| 1/4 | 0.250 | 6.4 | 3/8 | 0.375 | 9.5 | 1 | 1.000 | 25.4 |
| 3/8 | 0.375 | 9.5 | 1/4 | 0.250 | 6.4 | 7/8 | 0.875 | 22.2 |
| 3/8 | 0.375 | 9.5 | 3/8 | 0.375 | 9.5 | 1-1/8 | 1.125 | 28.6 |
| 1/2 | 0.500 | 12.7 | 1/4 | 0.250 | 6.4 | 1 | 1.000 | 25.4 |
| 1/2 | 0.500 | 12.7 | 3/8 | 0.375 | 9.5 | 1-1/4 | 1.250 | 31.8 |
| 3/4 | 0.750 | 19.1 | 1/4 | 0.250 | 6.4 | 1-1/4 | 1.250 | 31.8 |
| 3/4 | 0.750 | 19.1 | 3/8 | 0.375 | 9.5 | 1-1/2 | 1.500 | 38.1 |
| 1 | 1.000 | 25.4 | 1/4 | 0.250 | 6.4 | 1-1/2 | 1.500 | 38.1 |
| 1 | 1.000 | 25.4 | 3/8 | 0.375 | 9.5 | 1-3/4 | 1.750 | 44.5 |
| 1-1/4 | 1.250 | 31.8 | 3/8 | 0.375 | 9.5 | 2 | 2.000 | 50.8 |
| 1-1/2 | 1.500 | 38.1 | 3/8 | 0.375 | 9.5 | 2-1/4 | 2.250 | 57.2 |